

- DECK No. 10 (COMPASS DECK)
- DECK No. 9 (BRIDGE DECK)
- DECK No. 8 (SUN DECK)
- DECK No. 7 (PROMENADE DECK)
- DECK No. 6 (RESTAURANT DECK)
- DECK No. 5 (MAIN DECK)
- DECK No. 4 ('A' DECK)
- DECK No. 3 ('B' DECK)
- DECK No. 2 ('C' DECK)
- DECK No. 1 ('D' DECK)

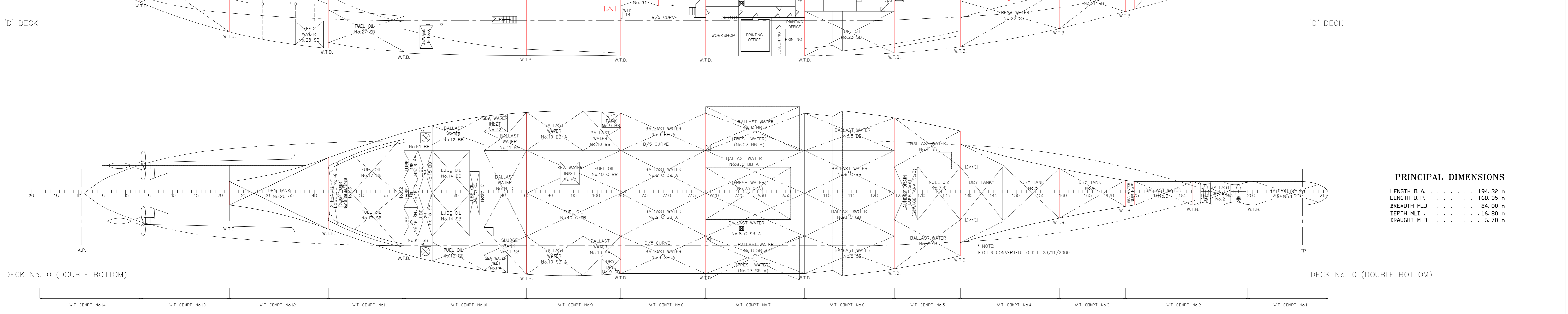
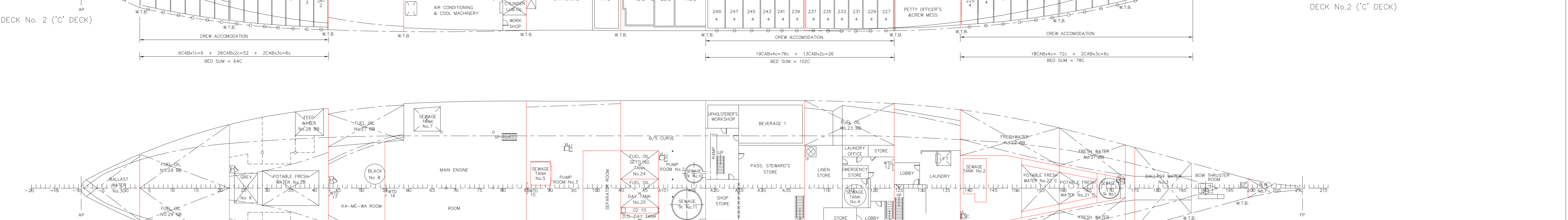
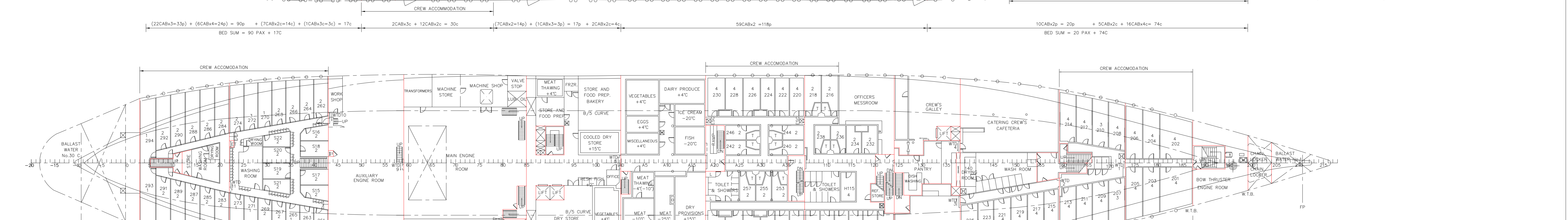
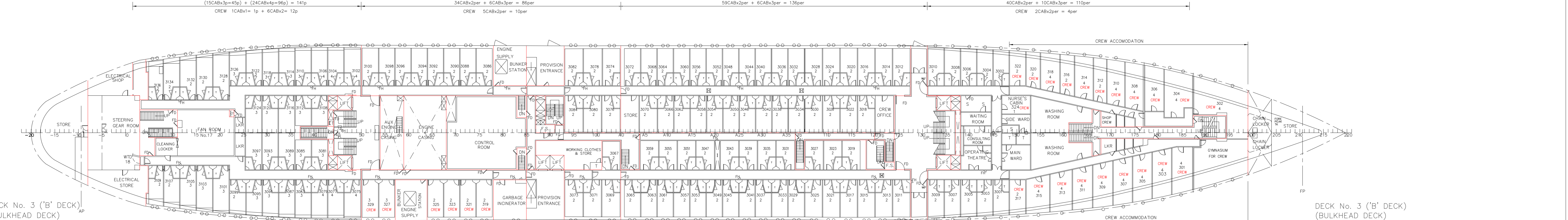
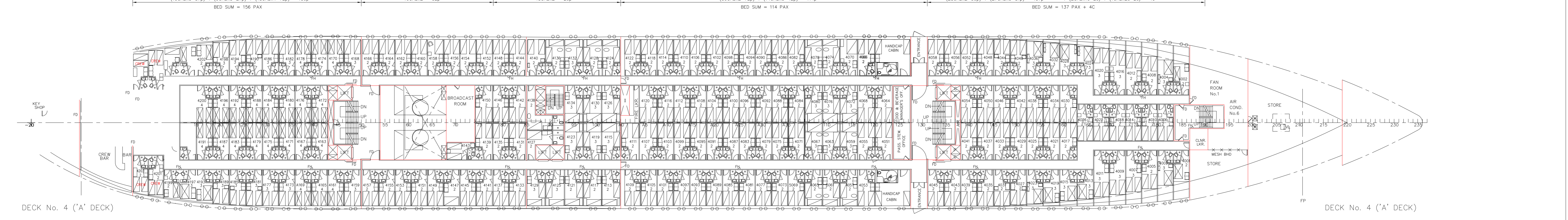
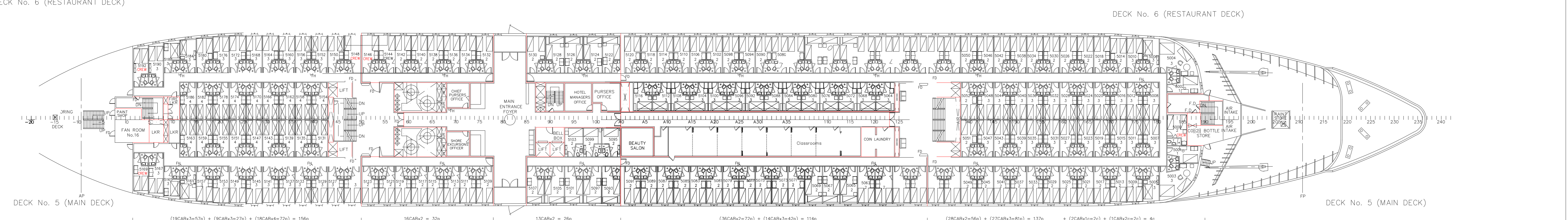
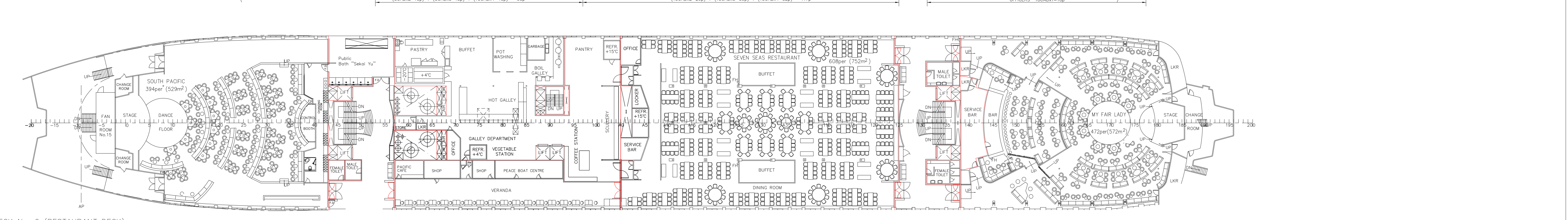
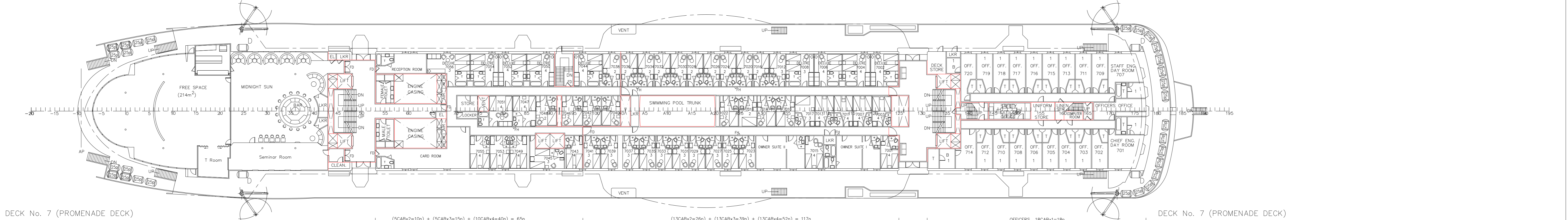
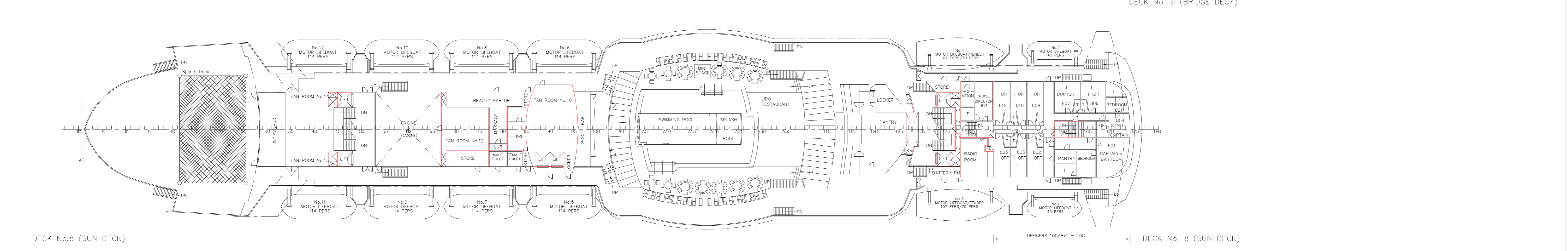
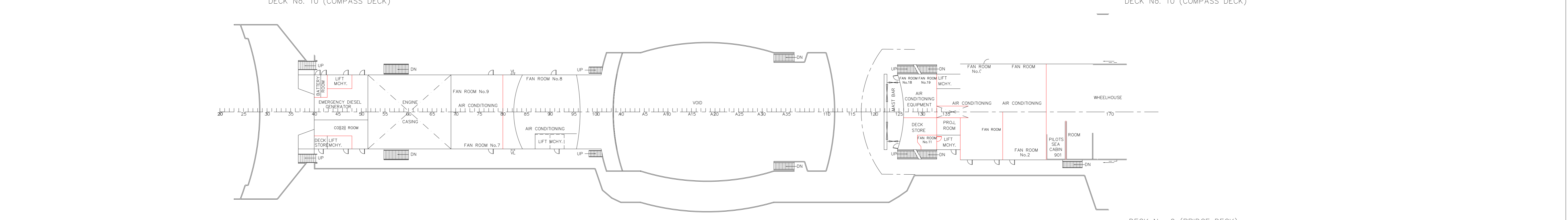
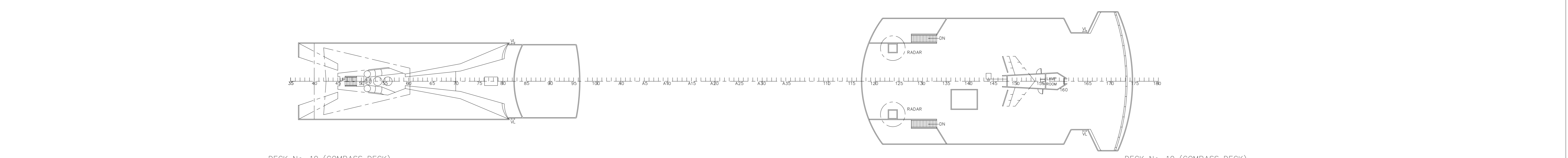

PRINCIPAL DIMENSIONS

LENGTH D.A.	194.38 m
LENGTH B.P.	168.35 m
BREADTH M.L.D.	24.00 m
DEPTH M.L.D.	16.80 m
DRAUGHT M.L.D.	6.70 m

DATE: 10.12.2009

M/V 'CLIPPER PACIFIC'
ex. M/V 'DREAM'

NAVAL ARCHITECTURE PROGRESS
NAVAL ARCHITECTS: SHIP DESIGN - MARINE CONSULTING ENGINEERS & ARCHITECTS
CONSULTANTS OF HULLSHELLS & WALKER SHIP CONSTRUCTION
HEAD OFFICE: 45/46 HONG KONG STREET, HONG KONG - OFFICE: 180-25
BULEVARDE DES FOSSES NOUVELES, PARIS 13^e - FRANCE
E-MAIL: info@progressna.com, progressna@progressna.com

GENERAL ARRANGEMENT

THE NAVAL ARCHITECT	DATE: APRIL 2008
SCALE:	1:250
REVISION:	C
DRAWN BY:	

DWG No. D19-05

THIS DRAWING IS OF NAVAL ARCHITECTURE PROPERTY AND MUST NOT BE COPIED, REPRODUCED OR USED FOR ANY PURPOSE OTHER THAN THAT SPECIFIED WITHOUT NAVAL ARCHITECTS PERMISSION.